

**CITY OF ALLENTOWN, PA
CROSSOVER APPLICATION**

- WARRANT OF SURVEY NO. _____
- WORK ORDER NO. _____
- RESIDENTIAL CROSSOVER FEE _____
- COMMERCIAL CROSSOVER FEE _____

Dept. of Public Works
CITY OF ALLENTOWN
BRIDGEWORKS
641 SOUTH 10TH STREET 3RD FL
ALLENTOWN PA 18103-3173

Date _____

I hereby request permission to construct _____ crossover(s) in the width of _____ feet to be used as an entrance and exit to a _____ located at _____.

CONTRACTOR

OWNER

Name

Name

Address

Address

Phone

Phone

Signature _____

DRAW LOCATION OF PROPOSED CROSSOVER ON REVERSE SIDE OF THIS FORM

Approved:

Bureau of Engineering

Bureau of Traffic Planning & Control

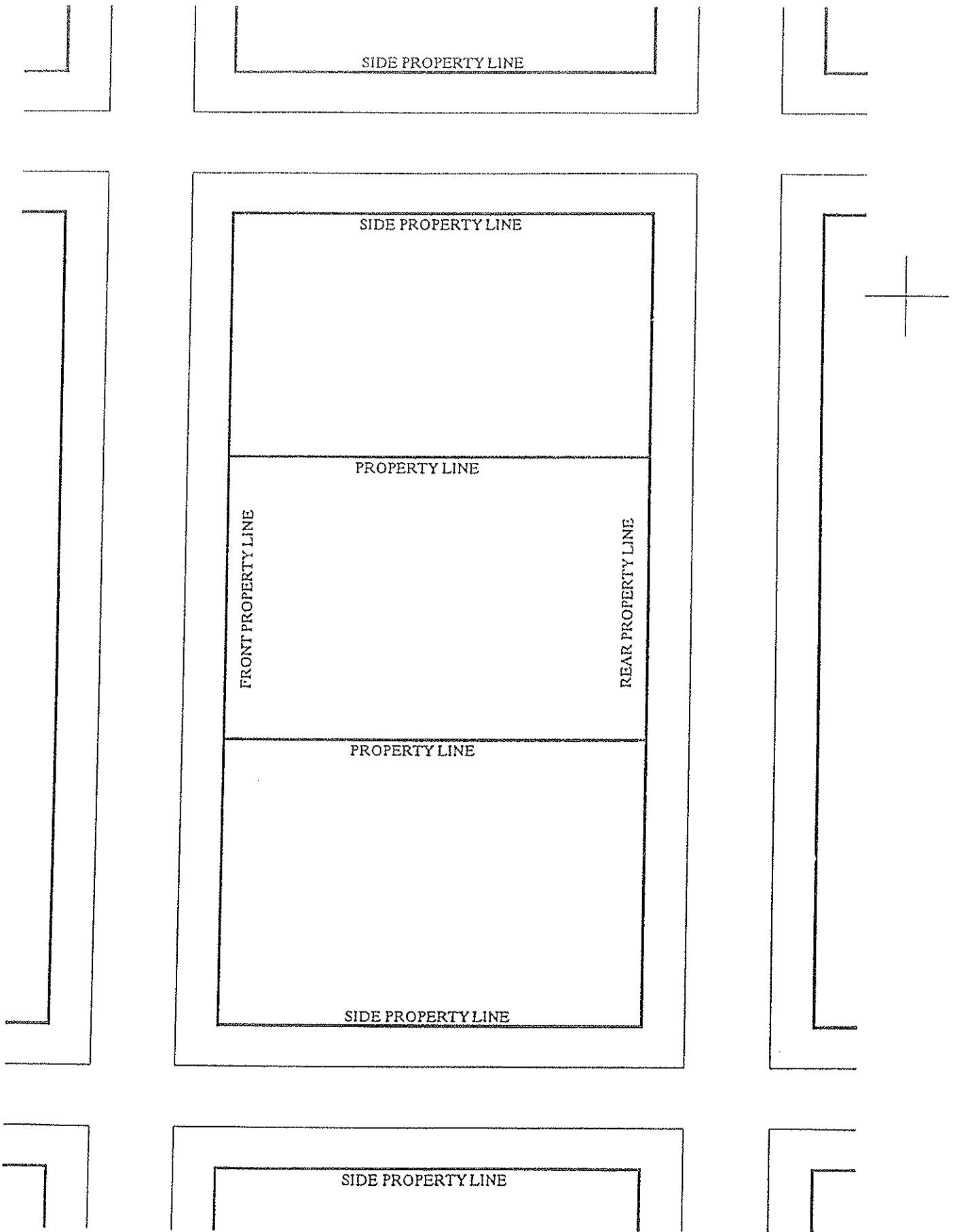

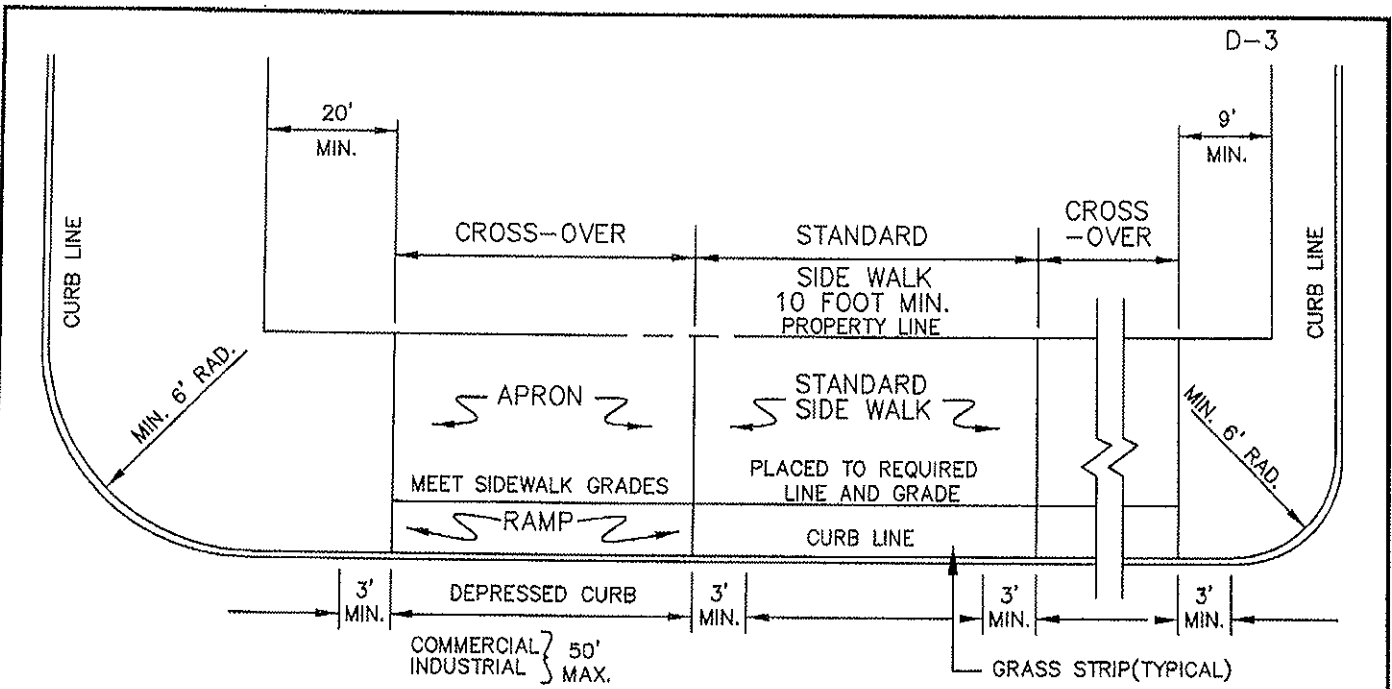

SIDEWALK AND RAMP CONSTRUCTED IN 2 SEPERATE POURS, PROVIDE 12" LONG #4 REBAR DOWELS @ 12" ON CENTER ALONG RAMP/WALK INTERFACE.

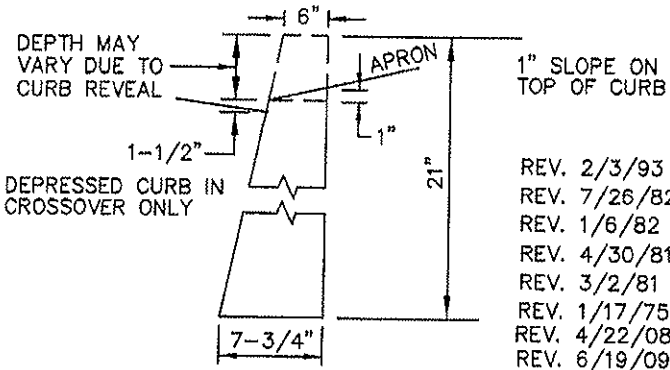
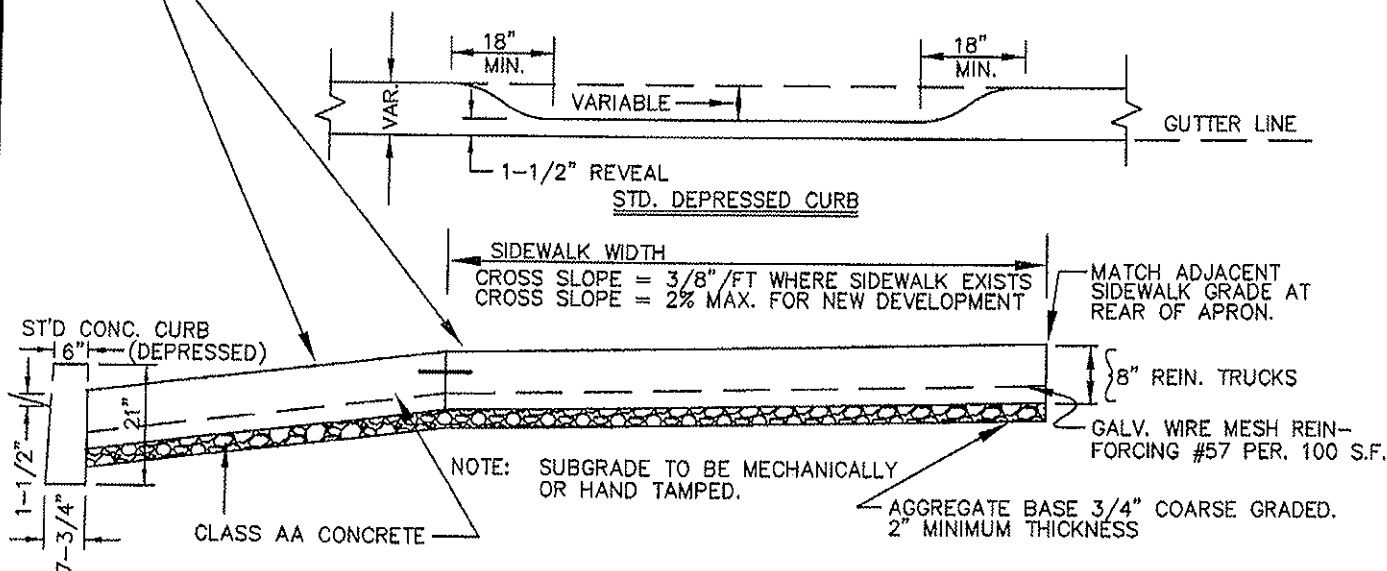

- REV. 2/3/93
- REV. 7/26/82
- REV. 1/6/82
- REV. 4/30/81
- REV. 3/2/81
- REV. 1/17/75
- REV. 4/22/08
- REV. 6/19/09

CITY OF ALLENTOWN, PA. DEPT. OF PUBLIC WORKS BUREAU OF ENGINEERING			
COMMERCIAL & INDUSTRIAL REQUIREMENTS FOR CROSS-OVERS			
DATE	SCALE	DWN. BY	DEPT. DIRECTOR NEAL E. KERN
11/2004	NONE	RLS	PAVING ENGINEER HAROLD NEFF